

Slit coupling (D1=06 / D2=06)

For encoder with solid shaft

Article number: 11034143

Overview

- Backlash-free and angularly synchronous transmission of rotary motion
- Medium torsional spring stiffness
- Small restoring forces
- Electrically isolating
- Vibration damping



Technical data

Technical data

Shaft diameter D1	6 mm
Shaft diameter D2	6 mm
Operating speed	≤12000 rpm
Operating temperature	-10...+80 °C
Moment of inertia	2 gcm ²
Torsional rigidity	12 Nm/rad
Radial spring stiffness	45 N/mm

Technical data

Maximum torque	30 Ncm
Admissible axial movement	± 0.2 mm
Admissible parallel misalignment	± 0.3 mm
Admissible angular error	± 2.5 °
Weight approx.	6 g
Material	Body: plastic Hexagon terminals: brass

Dimensions

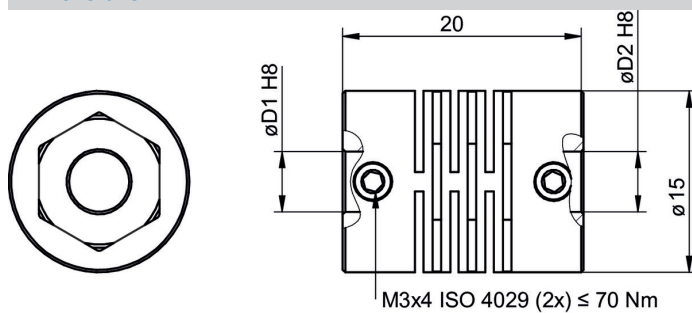

Slit coupling (D1=06 / D2=06)

For encoder with solid shaft

Article number: 11034143

Assembly drawing

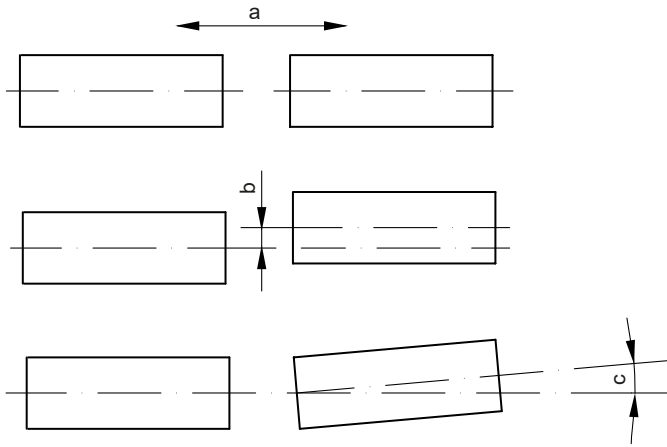

a = Admissible axial movement
b = Admissible parallel misalignment
c = Admissible angular error