

OHDM 16N5001/S14

Diffuse sensors with background suppression - standard

Article number: 10241873

Overview

- background suppression
- 25 ... 300 mm
- pulsed red laser diode
- NPN
- mechanical, 8 turn
- connector M12 4 pin
- -10 ... 50 °C
- IP 67



Picture similar



Technical data

General data

Type	Background suppression
Light source	Pulsed red laser diode
Sensing distance T_w	25 ... 300 mm
Sensing range T_b (at T_w max.)	40 ... 300 mm
Sensing range T_b (at T_w min.)	5 ... 25 mm
Repeat accuracy	< 0.1 mm at laser focus
Output indicator	LED yellow
Sensing distance adjustment	Mechanical, 8 turn
Laser class	2
Distance to focus	80 mm
Wave length	650 nm
Suppression of reciprocal influence	Yes

Electrical data

Response time / release time	< 0.6 ms
Voltage supply range +Vs	10 ... 30 VDC

Electrical data

Current consumption max. (no load)	35 mA
Current consumption typ.	25 mA
Voltage drop V_d	< 2 VDC
Output function	Light / dark operate
Output circuit	NPN
Output current	< 200 mA
Short circuit protection	Yes
Reverse polarity protection	Yes

Mechanical data

Width / diameter	15.4 mm
Height / length	50 mm
Depth	50 mm
Type	Rectangular
Housing material	Die-cast zinc
Front (optics)	Glass
Connection types	Connector M12 4 pin

Ambient conditions

Protection class	IP 67
Operating temperature	-10 ... +50 °C

OHDM 16N5001/S14

Diffuse sensors with background suppression - standard

Article number: 10241873

Dimension drawing

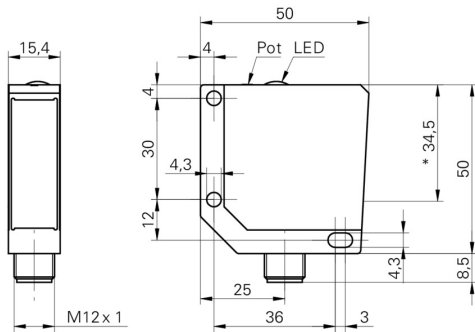

- * emitter axis

Laser warning

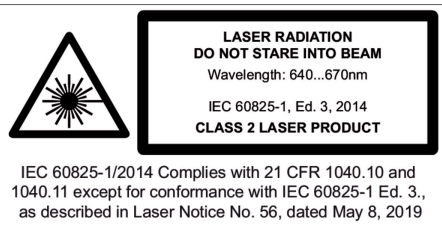

Connection diagram

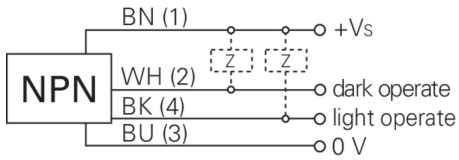

Beam characteristic (typically)

