

## Connector M12 x 1 with attached PE-X-cable, shielded

### dimension drawing

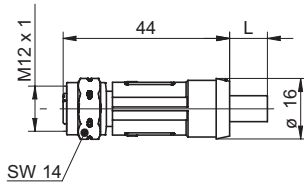

- For outdoor applications
- 4 wire, shielded
- Shield connected with cap nut
- External sheath consisting of PE-X
- Halogen free
- High grade steel cap nut (1.4401)

### General data

Nominal current $I_N$	4 A
Nominal voltage $U_N$	250 V
Number of positions	4
Volume resistance	$\leq 5 \text{ m}\Omega$
Insulation resistance	$\geq 100 \text{ M}\Omega$
Length of cable	see listing
Ambient temperature (operation)	-40 ... 105 °C -40 °C ... 85 °C (On sudden changes in temperature (according to IEC 60512-11-4))

### General characteristics

Coding	A-standard
Pollution degree	3
Degree of protection	IP65/IP67/IP68/IP69K
Torque	0.4 Nm (M12 connector)
Contact material	CuSn
Contact surface material	Ni/Au
Contact carrier material	PP
Material of grip body	PP
Material, cap-nut	High-grade steel 1.4401
Seal material	FPM
Status display	no

### Conductor data

Cable type	PE-X halogen-free black, shielded
Cable abbreviation	Li2X2X-C-VI-2X
Conductor cross section	0,5 mm <sup>2</sup>
AWG signal line	20
Conductor structure, signal line	28x0,15 mm
Core diameter including insulation	1,6 mm $\pm$ 0,05 mm
Thickness, insulation	ca. 0,3 mm (Core insulation) ca. 0,7 mm (Outer cable sheath) ca. 0,45 mm (Inner sheath)
External cable diameter	6,8 mm $\pm$ 0,2 mm
Wire colors	Brown, white, blue, black
External sheath, color	Black-gray RAL 7021

type	Mat.-No.	length
<b>straight connectors</b>		
ESG 34AE0500G	11087738	5 m
ESG 34AE1000G	11087739	10 m

other lengths on request

### pin assignment

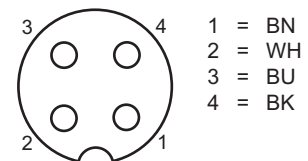

Technical specifications subject to change Page 1/2

## Connector M12 x 1 with attached PE-X-cable, shielded

Conductor data (cont.)	
Conductor resistance	max 39 $\Omega$ /m (at 20 °C)
Nominal voltage, conductor	$\leq$ 300 V
Test voltage, conductor	$\geq$ 3000 V
Overall twist	4 wires, twisted
Length of twist, overall twist	108,8 mm
Shielding	Braided copper wires
Optical shield covering	85 %
Outer sheath, material	PE-X
Material conductor insulation	PE-X
Material conductor insulation	PE-X
Conductor material	Bare Cu litz wires
Cable weight	74 kg/km
Smallest bending radius, fixed installation	34 mm
Smallest bending radius, movable installation	68 mm
Number of bending cycles	1'000'000
Bending radius	68 mm
Traversing path	10 m
Traversing rate	3 m/s
Acceleration	10 m/s <sup>2</sup>
Ambient temperature (operation)	-40 ... 105 °C (cable, fixed installation) -15 ... 105 °C (cable, flexible installation)
Flame resistance	According to DIN 60332-1-2 According to DIN EN 50266-2-5
Halogen-free	in accordance with DIN VDE 0472 part 815
Resistance to oil	in accordance with DIN EN 60811-2-1
Other resistance	UV resistant According to DIN VDE 0276-605