

Spring washer coupling (D1=6 / D2=10)

For encoder with solid shaft

Article number: 10141132

Overview

- Backlash-free and angle-synchronous transmission of rotary movements
- Plug-in version
- Electric isolated
- Suitable for very high speeds
- Good compensation of all misalignments



Technical data

Technical data

Shaft diameter D1	6 mm
Shaft diameter D2	10 mm
Operating speed	≤12000 rpm
Operating temperature	-10...+80 °C
Moment of inertia	35 gcm ²
Torsional rigidity	30 Nm/rad
Radial spring stiffness	40 N/mm

Technical data

Maximum torque	60 Ncm
Admissible axial movement	± 0.4 mm
Admissible parallel misalignment	± 0.3 mm
Admissible angular error	± 2.5 °
Weight approx.	30 g
Material	Clamping ring: aluminium Spring washer: plastic

Dimensions

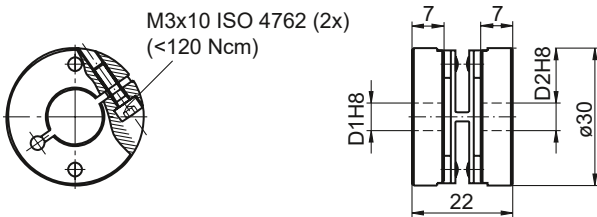

Spring washer coupling (D1=6 / D2=10)

For encoder with solid shaft

Article number: 10141132

Assembly drawing

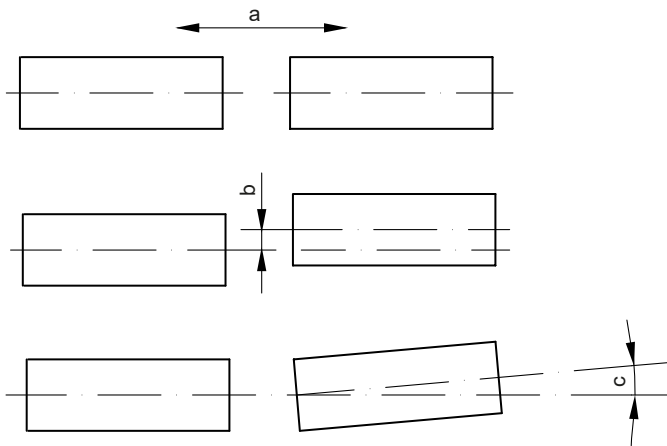

a = Admissible axial movement
b = Admissible parallel misalignment
c = Admissible angular error