

**Overview**

- pulsed red LED
- PNP
- Teach-in
- connector M8 4 pin
- -25 ... 55 °C
- IP 65



Picture similar



**Technical data**

**General data**

Version	Integrated alarm output
Sensing distance Tw (FUE 200C1003)	90 mm
Light source	Pulsed red LED
Light indicator	LED green
Alignment / soiled lens indicator	LED green, flashing
Output indicator	LED yellow
Adjustment	Teach-in
Wave length	660 nm

**Electrical data**

Response time / release time	< 1 ms
Voltage supply range +Vs	10 ... 30 VDC
Current consumption max. (no load)	46 mA
Current consumption typ.	36 mA

**Electrical data**

Voltage drop Vd	<1.8 VDC
Output function	Light / dark operate switchable
Output circuit	PNP
Output current	100 mA
Short circuit protection	Yes
Reverse polarity protection	Yes

**Mechanical data**

Width / diameter	12 mm
Height / length	33.2 mm
Depth	60 mm
Design	Rectangular
Housing material	PBT / PC
Connection types	Connector M8 4 pin

**Ambient conditions**

Operating temperature	-25 ... +55 °C
Protection class	IP 65

**Dimension drawing**

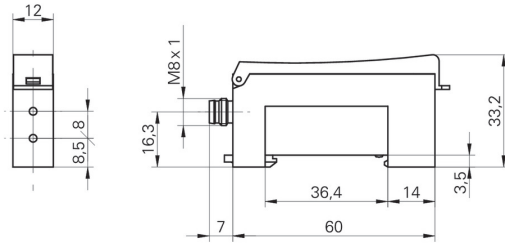

**Connection diagram**

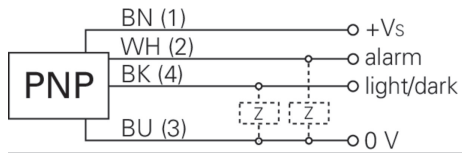

**Accessories**

**Mounting accessories**

10145702

10145702