

**Overview**

- diffuse contrast sensor
- 12,5 mm ±2 mm
- white LED
- push-pull
- Teach-in
- connector M8 4 pin
- -25 ... 65 °C
- IP 67



Picture similar



**Technical data**

**General data**

Type	Diffuse contrast sensor
Light source	White LED
Sensing distance Tw	12.5 mm ±2 mm
Light indicator	LED green
Output indicator	LED yellow
Sensitivity adjustment	Teach-in
Distance to focus	12,5 mm
Beam height	3 mm
Beam width	1 mm

**Electrical data**

Response time / release time	< 0.05 ms
Voltage supply range +Vs	18 ... 30 VDC
Current consumption max. (no load)	50 mA
Current consumption typ.	40 mA
Voltage drop Vd	< 3 VDC

**Electrical data**

Output function	Light / dark operate
Output circuit	Push-pull
Output current	< 100 mA
Short circuit protection	Yes
Reverse polarity protection	Yes

**Mechanical data**

Width / diameter	14.8 mm
Height / length	43 mm
Depth	31 mm
Type	Rectangular
Housing material	Plastic (ASA, MABS)
Front (optics)	PMMA
Connection types	Connector M8 4 pin

**Ambient conditions**

Protection class	IP 67
Operating temperature	-25 ... +65 °C

**Dimension drawing**

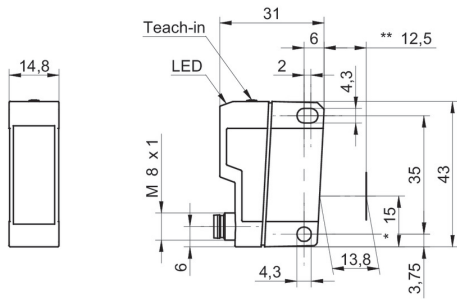

- \* emitter axis

**Connection diagram**

