

FHDM 16P5004/S14

Diffuse sensors with background suppression - standard

Article number: 10161124

Overview

- background suppression
- 20 ... 600 mm
- pulsed red LED
- PNP
- mechanical, 5 turn
- connector M12 4 pin
- -25 ... 65 °C
- IP 67



Picture similar



Technical data

General data

Type	Background suppression
Light source	Pulsed red LED
Sensing distance Tw	20 ... 600 mm
Sensing range Tb (at Tw max.)	20 ... 600 mm
Sensing range Tb (at Tw min.)	5 ... 20 mm
Light indicator	LED yellow
Sensing distance adjustment	Mechanical, 5 turn
Wave length	660 nm
Suppression of reciprocal influence	Yes

Electrical data

Response time / release time	< 5 ms
Voltage supply range +Vs	10 ... 30 VDC
Current consumption max. (no load)	41 mA

Electrical data

Current consumption typ.	29 mA
Voltage drop Vd	< 1.8 VDC
Output function	Light / dark operate
Output circuit	PNP
Output current	< 200 mA
Short circuit protection	Yes
Reverse polarity protection	Yes

Mechanical data

Width / diameter	15.4 mm
Height / length	50 mm
Depth	50 mm
Type	Rectangular
Housing material	Die-cast zinc
Front (optics)	PMMA
Connection types	Connector M12 4 pin

Ambient conditions

Protection class	IP 67
Operating temperature	-25 ... +65 °C

FHDM 16P5004/S14

Diffuse sensors with background suppression - standard

Article number: 10161124

Dimension drawing

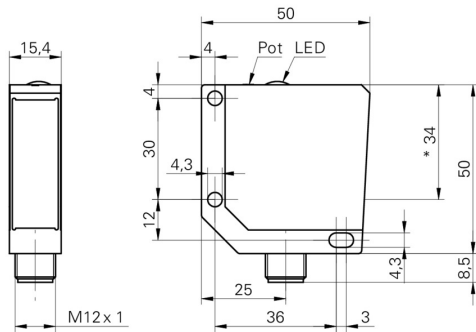

- * emitter axis

Connection diagram

